

CM2x10x3 CM5x10x3

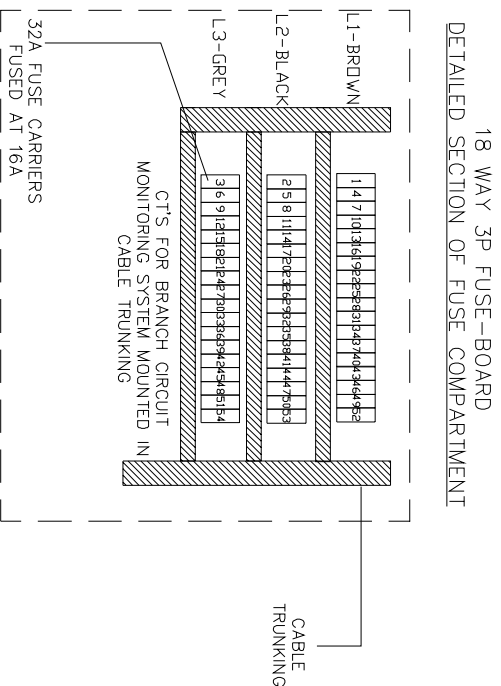
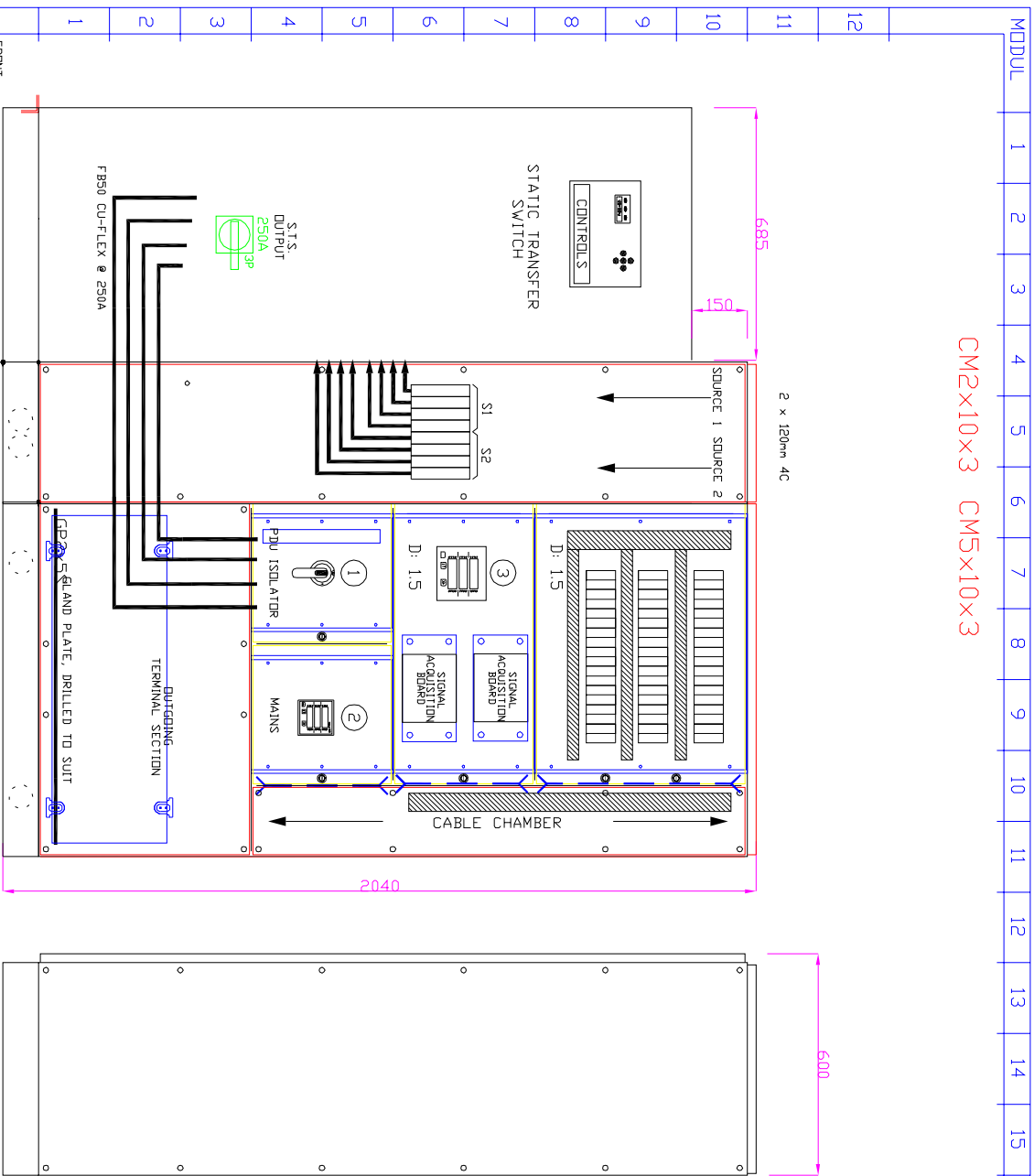

PDU/SIGNAL ACQUISITION BOARD	FUSES	TERMINALS (AV)
PDU 'A' BOARD 1	1 - 42	1 - 84
PDU 'X' BOARD 2	43 - 57	85 - 114
PDU 'B' BOARD 1	1 - 42	1 - 84
PDU 'B' BOARD 2	43 - 57	85 - 114
PDU 'C' BOARD 1	1 - 42	1 - 84
PDU 'C' BOARD 2	43 - 54	45 - 108
PDU 'D' BOARD 1	1 - 42	1 - 84
PDU 'D' BOARD 2	43 - 54	45 - 108

BOILER WARNING LIGHT	CURRENT
GREEN	BELOW 10A
AMBER	BETWEEN 10A AND 15A
RED	ABOVE 15A

Ref. No:	K4400-PDU	Colour:	RAL 7035	Standard:	IEC 60439-1	Main busbar:	250A 3P+N	Cable entry:	TOP	Rev:	03	Page No:	1	Width:	1862mm
Originator:	DK	IP:	43	Voltage:	415	IPK:	25KA	Cable exit:	BOTTOM	Checks:	DK	Next page:	2	Height:	2040mm
Date:	03/02/09	Form:	2 TYPE 2	Poles:	3 P+N	ICW:	25KA	Scale:	NTS	DWG No:	K4400-PDU	Depth:	600mm		
Drawing No:	K4400-PDU	Access:	FRONT	Earthing System:	-	Drawings:	N/A	Project:	BT TELEPHONE HOUSE	DWG Rev:	03				



KANE ENGINEERING LIMITED
 GLENFORD ROAD, NEWTOWNARDS, CO. DOW, NORTHERN IRELAND BT23 4AU
 Tel: 028 9181 4465
 Fax: 028 9181 8900
 www.LowVoltageSwitchgear.com