

MODUL	1	2	3	4	5	6	7	8	9	10	11	12	13	14	15	16	17	18	19	20	21	22	23	24	25
-------	---	---	---	---	---	---	---	---	---	----	----	----	----	----	----	----	----	----	----	----	----	----	----	----	----

CM4x10x3
E10108 - GOONVEAN CHINA CLAY - PROPOSED MAIN LV SWITCHBOARD

CM7x10x3
CM6x10x3

CM5x10x3

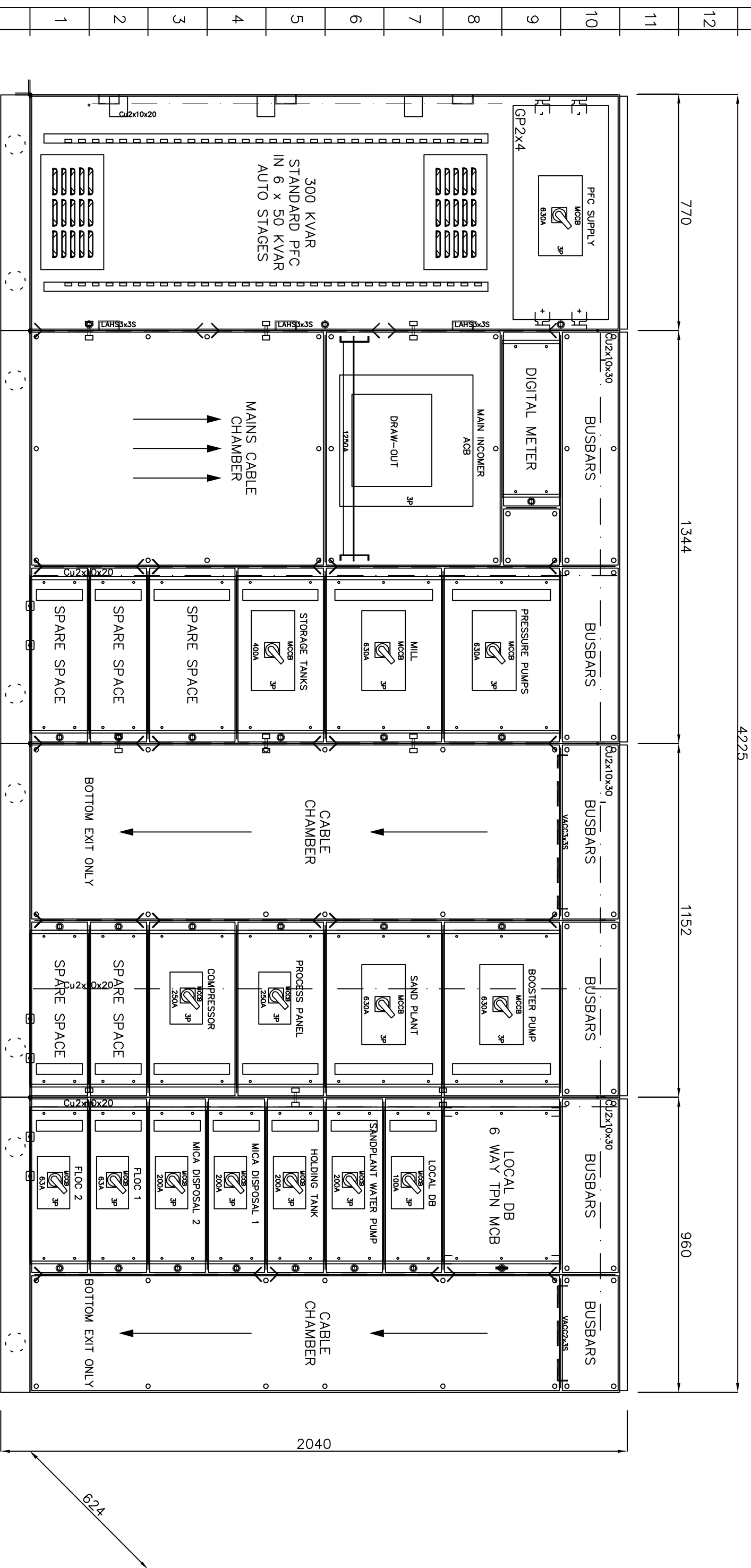

Ref. No.:	E10108	Colour:	RAL 7035	Standard:	IEC 60439-1	Main busbar:	1250A	Cable entry:	Bottom	Rev.:	00	Page No.:	1	Width:	4224mm
Originator:	DGK	Form:	4 type 2	Voltage:	440V	pk:	50KA	Cable exit:	Bottom	Check:	DK	Next page:	N/A	Height:	2040mm
Date:	06.12.05	Access:	Front	Poles:	3 P+N	cw:	35KA	Scale:	NTS	DWG No.:	E10108-L	Depth:	600mm		
Drawing No.:	E10108-PRE	Earthing System:	PME	Dropers:	1000A	Project:	Goonvean China Clay	DWG Rev.:	00						



KANE ENGINEERING LIMITED

GLENFORD ROAD, NEWTOWNARDS, CO. DOWN,
NORTHERN IRELAND BT23 4AU
Tel: 028 9181 4465
Fax: 028 9181 8900
www.LowVoltageSwitchgear.com